

Ferrule ~ Tube Clamp x Tube OD Weld

Liquidyne P/N : L1 14WMP-7-(size)-(material)
L2 L14AM7-7-(size)-(material)
L3 14WLMP-7-(size)-(material)

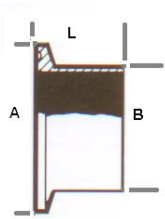

| Size | Ferrule OD/A | Tube OD/B | Tube Wall | L1 | L2 | L3 |
|-------|--------------|-----------|-----------|------|-------|-----|
| 1.0" | 1.984 | 1.0 | .065 | .500 | 1.125 | 3.0 |
| 1.5" | 1.984 | 1.5 | .065 | .500 | 1.125 | 3.0 |
| 2.0" | 2.516 | 2.0 | .065 | .500 | 1.125 | 3.0 |
| 2.5" | 3.047 | 2.5 | .065 | .500 | 1.125 | 3.0 |
| 3.0" | 3.579 | 3.0 | .065 | .500 | 1.125 | 3.0 |
| 4.0" | 4.682 | 4.0 | .083 | .500 | 1.125 | 3.0 |
| 5.0" | 5.692 | 5.0 | .109 | .500 | 1.125 | 3.0 |
| 6.0" | 6.570 | 6.0 | .109 | .500 | 1.125 | 4.0 |
| 8.0" | 8.570 | 8.0 | .109 | .625 | 1.125 | 4.0 |
| 10.0" | 10.570 | 10.0 | .135 | .875 | 1.500 | 6.0 |
| 12.0" | 12.570 | 12.0 | .135 | .875 | 1.500 | 6.0 |

Ferrule ~ Tube Clamp x Pipe Schedule Weld

Liquidyne P/N : Sch 5 B19MPV-R-(size)
Sch 10 B19MPX-R-(size)

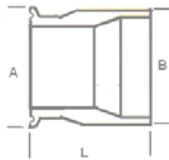

| Size | Ferrule OD/A | Pipe OD/B | Sch 5 Wall | Sch 10 Wall | L |
|------|--------------|-----------|------------|-------------|-----|
| 1.0" | 1.984 | 1.315 | .065 | .109 | 2.0 |
| 1.5" | 1.984 | 1.900 | .065 | .109 | 2.0 |
| 2.0" | 2.525 | 2.375 | .065 | .109 | 2.0 |
| 2.5" | 3.050 | 2.875 | .083 | .120 | 2.0 |
| 3.0" | 3.579 | 3.500 | .083 | .120 | 2.0 |
| 4.0" | 4.680 | 4.500 | .083 | .120 | 2.0 |
| 6.0" | 6.570 | 6.628 | .109 | .134 | 2.0 |
| 8.0" | 8.570 | 8.625 | .109 | .148 | 2.0 |

Ferrule ~ Pipe Schedule Clamp x Pipe Schedule Weld

Liquidyne P/N : Sch 5 TL14AMV-7-(size)-(material)
Sch 10 TL14AMX-7-(size)-(material)

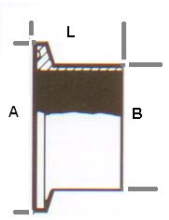

| Size | Ferrule OD/A | Pipe OD/B | Sch 5 Wall | Sch 10 Wall | L |
|------|--------------|-----------|------------|-------------|-----|
| 1.0" | 1.984 | 1.315 | .065 | .109 | 2.0 |
| 1.5" | 2.516 | 1.900 | .065 | .109 | 2.0 |
| 2.0" | 3.047 | 2.375 | .065 | .109 | 2.0 |
| 2.5" | 3.579 | 2.875 | .083 | .120 | 2.0 |
| 3.0" | 4.125 | 3.500 | .083 | .120 | 2.0 |
| 4.0" | 5.125 | 4.500 | .083 | .120 | 2.0 |

Note: This is a sampling of the sanitary ferrules offered by Liquidyne. For a complete list and to consult on your specific requirements contact Liquidyne at the number below.

Adapter ~ Tube OD Weld x Pipe Schedule Weld

Liquidyne P/N : Sch 5 E17WWV-7-(size)-(material)
Sch 10 E17WWX-7-(size)-(material)

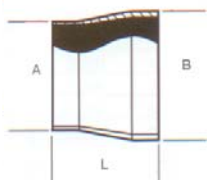

| Size | Tube OD/A | Tube Wall | Pipe OD/B | Sch 5 Wall | Sch 10 Wall | L |
|-------|-----------|-----------|-----------|------------|-------------|-----|
| 0.50" | 0.50 | .065 | 0.840 | .065 | .083 | 1.0 |
| 0.75" | 0.75 | .065 | 1.050 | .065 | .083 | 1.0 |
| 1.00" | 1.00 | .065 | 1.315 | .065 | .109 | 1.0 |
| 1.50" | 1.50 | .065 | 1.900 | .065 | .109 | 1.5 |
| 2.00" | 2.00 | .065 | 2.375 | .065 | .109 | 1.5 |
| 2.50" | 2.50 | .065 | 2.875 | .083 | .120 | 1.5 |
| 3.00" | 3.00 | .065 | 3.500 | .083 | .120 | 2.0 |
| 4.00" | 4.00 | .083 | 4.500 | .083 | .120 | 2.0 |
| 6.00" | 6.00 | .109 | 6.625 | .109 | .134 | 3.0 |

Sanitary Clamps

Liquidyne P/N : Tube P13MHHM-(size)
Pipe Sch 5 & 10 13MHHV-(size)

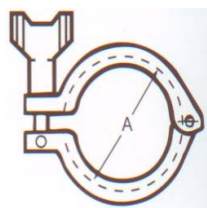

| Size | Tube/A | Pipe Sch 5 & 10/A |
|--------|--------|-------------------|
| 0.50" | 1.125 | 1.125 |
| 0.75" | 1.125 | 1.125 |
| 1.00" | 2.122 | 2.122 |
| 1.50" | 2.122 | 2.654 |
| 2.00" | 2.654 | 3.185 |
| 2.50" | 3.185 | 3.717 |
| 3.00" | 3.717 | 4.260 |
| 4.00" | 4.820 | 5.250 |
| 5.00" | 5.817 | - |
| 6.00" | 6.695 | 7.230 |
| 8.00" | 8.695 | - |
| 10.00" | 10.695 | - |
| 12.00" | 12.695 | - |

Note:

This is a sampling of the sanitary tube to pipe adapters, clamps and gaskets offered by Liquidyne. For a complete list and to consult on your specific requirements contact Liquidyne at the number below.

Sanitary Gaskets

Liquidyne P/N : Tube 0.5" & 0.75" 42MP(material)-(size)
Tube 1.0" & larger 40MP(material)-(size)
Pipe Sch 5 40MV(material)-(size)



Liquidyne inventories gaskets in both tube and pipe sizes, available in both Type I and Type II (flanged).

The following is a list of materials available:

| | |
|----------|-----------------|
| EPDM | Teflon |
| Silicone | Teflon Envelope |
| Viton | Tuf-Flex |
| Buna-N | Teflon/316SS |